

日期	次数	变更内容	编制人	日期
2025.06.04	1	增加生成日期	李亮亮	

ECR记录: ECR25060051

德尔玛说明书印刷要求

颜色规范:

 黑色印刷
C0 M0 Y0 K100

 专色印刷
PANTONE123 C
C0 M20 Y100 K0

 内容印刷
C0 M0 Y0 K70

 内容印刷
C0 M0 Y0 K50

 内容印刷
C0 M0 Y0 K15

材质+工艺:

材质双胶纸80克, 风琴折
4色+1专

尺寸:

成品尺寸: 90×210mm,
展开尺寸: 540×210mm

技术要求:

- 1、色相正确、印迹牢固、套印准确、各色套印不露杂色, 套印误差≤ 0.1mm, 模切走位±1mm;
- 2、带*尺寸为重点检查尺寸。

规格尺寸表 (单位: mm)		版本	A1
规格尺寸	规格	产品型号	81200-S
81200	81200	物料名称	说明书
150*4	±0.05	料号	81200-45170-00022
150*20	±0.1	材料	无技术要求
100~120	±0.1	规格	
100~100	±0.2	净重	
100~1000	±0.3	比例	1:1
1000~2000	±0.4	单位	mm
2000~4000	±0.5	第 1 页 共 1 页	



Cleaning & Maintenance

Dirty Water Tank Cleaning

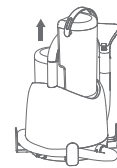

1. Flip the handle and lift the dirty water tank vertically from the main unit.



2. Remove the dirty water tank cover.

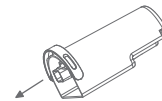

3. Pour out the dirty water in the direction shown, then rinse the tank with clean water and air-dry.



4. Remove the sponge from the tank cover as illustrated, rinse the cover with clean water, then air-dry both the sponge and cover.

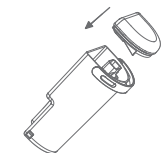

5. After drying the tank (air-dry or blow-dry), reattach the cover.

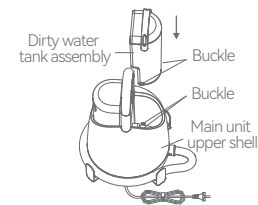

6. Reinstall the dirty water tank assembly by aligning the two buckles on the main unit's upper shell with the tank's buckles (as shown in the diagram).

Note:
The unit's exterior can be wiped with a dry or slightly damp cloth and always unplug the device before cleaning.

Troubleshooting

Note: Before troubleshooting, disconnect the power supply and unplug the power cord.

Malfunction	Causes	Solutions
Brush head suction weakens	Dirty water tank is full	Empty the dirty water tank
	Pipe is clogged	Check for clogs in the pipe and clean if necessary
	Machine has been used for too long	Power off and let the machine cool for at least 10 minutes before reuse
No water spray from nozzle	Clean water tank is empty	Refill the clean water tank
Machine does not respond to function buttons	Power plug is not connected	Plug in the power cord securely
No hot water spraying, the water temperature switch button and the suction adjustment button flash red lights	The NTC temperature sensor has failed	Contact the customer service and return the product to the factory for repair
Poor water absorption by brush head	Hose is not properly attached to the main unit	Disconnect and reattach the hose to the main unit properly
	Dirty water tank lid is not securely fitted	Reinstall the dirty water tank lid correctly
	Dirty water has reached the MAX level line	Clean the dirty water tank before reuse

If abnormalities or faults cannot be resolved:
Immediately stop using the cleaner and unplug the power cord to avoid electric shock.
Contact after-sales service for assistance.

Technical Parameter

Product Name: Water-absorbing Vacuum Cleaner (Fabric & Upholstery Cleaner)
Product Model: BYAD12B
Rated Power: 1200 W
Rated Voltage / Frequency: 220-240 V ~ /50-60 Hz
Suction Power: 400 W
Capacity of Clean Water Tank: 1.7 L
Capacity of Dirty Water Tank: 1.4 L

Environment Protection



All products bearing this symbol are waste electrical and electronic equipment (WEEE as in directive 2012/19/EU) which should not be mixed with unsorted household waste. Instead, you should protect human health and the environment by handing over your waste equipment to a designated collection point for the recycling of waste electrical and electronic equipment, appointed by the government or local authorities. Correct disposal and recycling will help prevent potential negative consequences to the environment and human health. Please contact the installer or local authorities for more information about the location as well as terms and conditions of such collection points.

User Manual

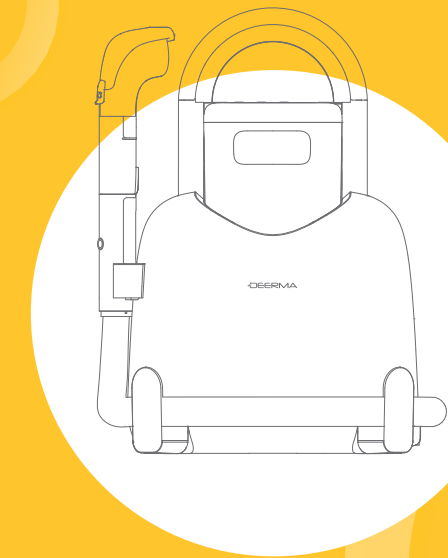

BY200 S

Deerma
Fabric & Upholstery Cleaner

3 Multifunctional Brush Assemblies
Standard Brush/Wide Fan Brush/Glass Brush

Read user manual carefully before use

Safety Instructions

This product is for household use only. Before operating, carefully read and retain the user manual.

- Intended for indoor cleaning (e.g., beds, sofas, carpets). Do not use outdoors, commercially, or in industrial environments.
- This appliance is not intended for use by persons (including children) with reduced physical, sensory or mental capabilities, or lack of experience and knowledge, unless they have been given supervision or instruction concerning use of the appliance by a person responsible for their safety.
- This appliance can be used by children aged from 8 years and above and persons with reduced physical, sensory or mental capabilities or lack of experience and knowledge if they have been given supervision or instruction concerning use of the appliance in a safe way and understand the hazards involved. Children shall not play with the appliance. Cleaning and user maintenance shall not be made by children without supervision.
- Children should be supervised to ensure that they do not play with the appliance.
- The plug must be removed from the socket-outlet before cleaning or maintaining the appliance.
- Do not touch the plug or any electrical parts with wet hands – risk of electric shock.
- Do not immerse or rinse any part of the product except removable components. Avoid direct sunlight or incineration.
- Always unplug before cleaning or maintenance.
- If the supply cord is damaged, it must be replaced by the manufacturer, its service agent or similarly qualified persons in order to avoid a hazard.
- Do not vacuum: hot materials (e.g., lit cigarettes, matches, hot ashes), fine particles (e.g., lime, cement, sawdust, plaster, ash, charcoal powder) and hazardous substances (e.g., solvents, corrosive chemicals) or unknown materials.
- Do not vacuum flammable/toxic liquids (e.g., gasoline, chlorine bleach, ammonia, drain cleaners).
- Avoid sharp objects (e.g., glass, toys, pins, stones, large paper) to prevent clogs or damage.
- Store away from heat/moisture (e.g., radiators, kitchens, bathrooms).
- If malfunction occurs (overheating, unusual noise/smell, weak suction), contact official after-sales service do not attempt repairs.
- Do not disassemble non-removable parts – risk of injury.
- Ensure the clean water tank and dirty water tank are correctly installed before use.
- Keep the unit dry to avoid short-circuiting or fire.
- Power off and unplug before winding the power cord.
- Minor water residue in tanks is normal (factory-tested for quality assurance).
- Please follow instructions to avoid damage, misuse voids liability.

Product Introduction

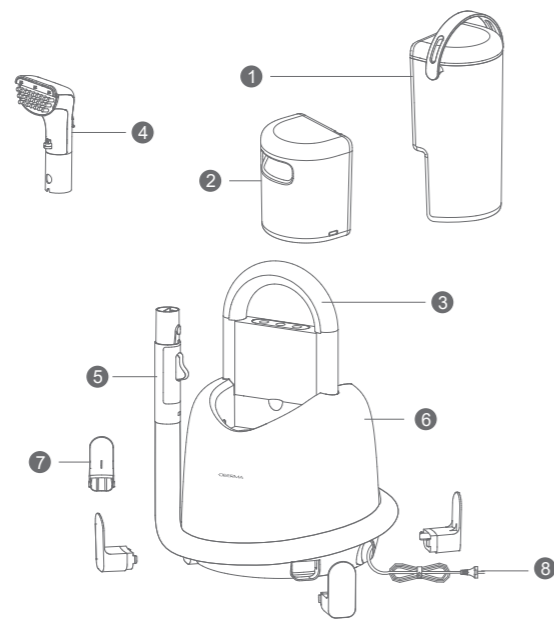

- 1 Dirty Water Tank
- 2 Clean Water Tank
- 3 Handle
- 4 Standard Brush
- 5 Hose
- 6 Main Unit
- 7 Hose Holder
- 8 Power Cord

Packing List

Parts Name	Quantity
Main Unit	1
Standard Brush	1
Hose	1
Hose Holder	4
User Manual	1
Wide Fan Brush (Including the brush assembly)	1
Glass Brush	1

Packing List

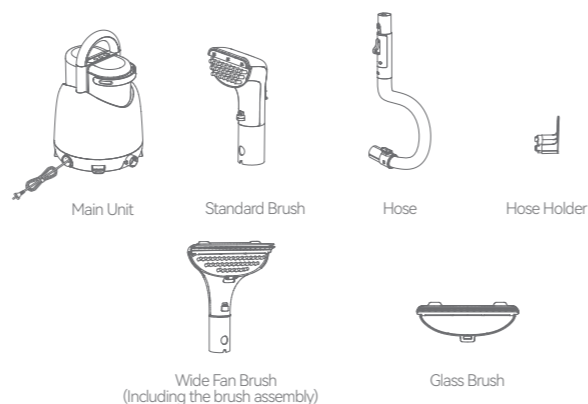

Installation

Installation of Main Unit

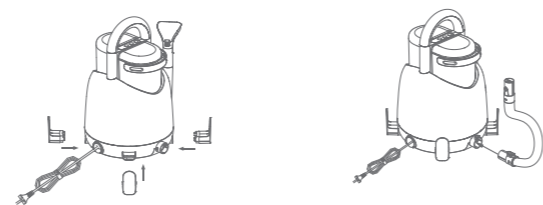

- Open the packaging, take out the main unit, and insert the four hose holders into their corresponding positions on the main unit.
- Insert the hose into the corresponding position on the main unit, ensuring it cannot be pulled out in reverse.



- Then insert the brush head into the hose connector until a "click" sound is heard, indicating proper installation.

Installation

Installation of Glass Brush



- Remove the brush assembly from the wide fan brush.
- Attach one end to the viewing window, then rotate to install the glass brush until a "click" sound indicates secure installation.

Operation

Adding Water to the Clean Water Tank



- Remove the clean water tank as shown in the diagram.
- Unscrew the clean water tank cap as shown in the diagram.

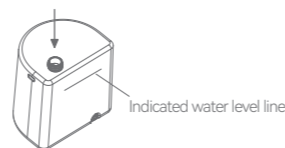

- Fill the clean water tank with clean water. Do not exceed the indicated water level line.

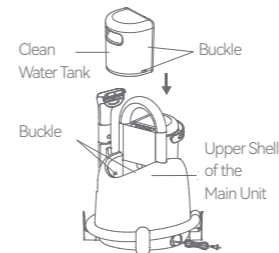

- Insert the filled clean water tank back into the main unit. Ensure the clean water tank is properly installed.

Operation

Power On/Off

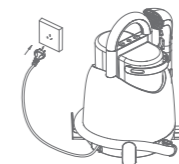

Power On
Remove the power cord from the main unit and connect it to the power supply, then lightly press the [Power Button] to start the machine. The default setting upon startup is hot water mode. Press the [Water Temperature Switch Button] for normal temperature water.

Power Off
After use, press the [Power Button] again to shut down.

Note: Always power off and unplug after cleaning, promptly empty the dirty water tank and clean the brush head.

Button Instructions

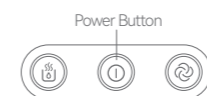

- Power Button**
Press the [Power Button] lightly to turn on (white indicator light).
Press [Power Button] again to turn off, light turns off.
The machine defaults to Hot water mode when powered on.



- Water Temperature Switch Button**
Press the [Water Temperature Switch Button] lightly to switch to normal temperature water (white indicator light).
Press the [Water Temperature Switch Button] again to switch to hot water (red indicator light).

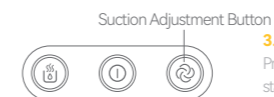

- Suction Adjustment Button**
Press the [Suction Adjustment Button] lightly to switch the standard mode (White indicator light).
Press [Suction Adjustment Button] again to switch the MAX mode (Red indicator light).

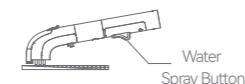

- Water Spray Button**
Hold the brush handle and press the [Water Spray Button] to activate water spray. Release the button to stop spraying.

Cleaning & Maintenance

Pipeline Self-Cleaning Mode

Standard Self-Cleaning

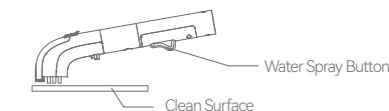

- Ensure the clean water tank is filled and the machine is powered on. Hold the brush head with bristles flat against a clean surface. Press and hold the [Water Spray Button] to wash the internal tubing.



- Unplug the machine before servicing. Slide off the transparent cover (follow arrow direction). Wash the cover separately.
- Dry the transparent cover completely before reattaching.

Deep Self-Cleaning

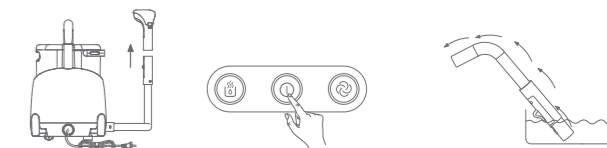

- Remove the brush head.
- Press the power button to turn on the device.
- Place the hose in a water container to draw water and complete the self-cleaning process.