

# 德尔玛说明书印刷要求

## 颜色规范:

 黑色印刷  
C 0 M 0 Y 0 K 100

 专色印刷  
PANTONE116 C  
C 0 M 14 Y 100 K 0

 内容印刷  
C 0 M 0 Y 0 K 5

 LOGO-灰色及部分内容印刷  
C 0 M 0 Y 0 K 50

**材质+工艺:**  
**1专+4色印刷**  
材质双胶纸80克, 折页

**尺寸:**  
成品尺寸: 90×210mm,  
展开尺寸: 900×210mm

### 技术要求:

- 1、色相正确、印迹牢固、套印准确、各色套印不露杂色, 套印误差 $\leq 0.1\text{mm}$ , 模切走位 $\leq \pm 1\text{mm}$ ;
- 2、带\*尺寸为重点检查尺寸。

未注公差带 GB/T 1804-2000				
基本尺寸	精密f	中等m	粗糙c	最粗v
0.5~3	$\pm 0.05$	$\pm 0.1$	$\pm 0.2$	-
>3~6	$\pm 0.05$	$\pm 0.1$	$\pm 0.3$	$\pm 0.5$
>6~30	$\pm 0.1$	$\pm 0.2$	$\pm 0.5$	$\pm 1$
>30~120	$\pm 0.15$	$\pm 0.3$	$\pm 0.8$	$\pm 1.5$
>120~400	$\pm 0.2$	$\pm 0.5$	$\pm 1.2$	$\pm 2.5$
>400~1000	$\pm 0.3$	$\pm 0.8$	$\pm 2$	$\pm 4$
>1000~2000	$\pm 0.5$	$\pm 1.2$	$\pm 3$	$\pm 6$
>2000~4000	-	$\pm 2$	$\pm 4$	$\pm 8$

 **德尔玛**

视角



页数

第 1 页 共 1 页

版本

A0

产品型号

T20 Flip

物料名称

说明书

图号

T20FLIP-M3170-00002

材质

见技术要求

图框

A4

净重

/

比例

1: 1

单位

mm

5	6
标记	处数

5	6
变更内容	编制人

5	6
日期	

• **Care and Maintenance** EN

**Emptying the dust cup**

Method 1:

- a. Open
- b. Close

1. Push the dust cup bottom cover release trigger and the dust cup bottom cover automatically pops open to dump the trash inside the dust cup.
  2. After cleaning, close the dust cup bottom cover in the direction of the arrow.
- Fig. E-1

Method 2:

1. Hold the dust cup release button, pull the dust cup forward, then lift it upward.
2. Separate the dust cup from the main unit.
3. Press the dust cup bottom cover release button to open the bottom cover as illustrated.
4. After emptying, close the bottom cover in the direction of the arrow.

- a. Dust cup bottom cover release button
- Fig. E-2

Note:  
This line indicates the effective volume of the dust cup: 0.4 L.  
The maximum volume of the dust cup is: 0.56 L.

Fig. E-3

**Cleaning the dust cup and filter assembly**

- a. Filter
- b. Filter sponge
- c. Cyclone separator

1. After removing the dust cup, separate the cyclone separator from the dust cup. Remove the filter and filter sponge from the cyclone separator in turn, following the directions shown in the illustration.

2. Remove dust from the surface of the dust cup, cyclone separator, filter sponge and filter. Rinse them with water until clean and air dry completely before reuse.

3. Reinstall all parts into the dust cup in original order, aligning slots for proper fit.

Note:  
• According to the actual use, it is recommended to clean the filter once after every vacuuming for one month.  
• All components must be fully dry before reassembly. Avoid sun exposure.  
• If suction weakens, clean the dust cup promptly to maintain vacuum efficiency.

Fig. E-4

• **Care and Maintenance** EN

**Cleaning the soft roller brush head assembly**

a. Brush side cover release button

1. Press the brush side cover release button, squeeze the side cover and remove the roller brush.
2. Clean out any hair and debris tangled on the roller brush with a suitable tool. After cleaning, reinstall the roller brush until you hear a click.

Fig. E-5

**Cleaning the accessories**

1. Remove the accessory from the main unit, wipe it with a damp cloth and dry it completely before reinstalling or storing it in the packaging box.

Note: Do not use gasoline, alcohol, solvents, or other alternative substances as they may damage the surface.

• **Battery Removal and Disposal** EN

Before discarding the appliance, the battery must be removed from the appliance.

When removing the battery, the appliance must be powered off.

The battery should be disposed of safely.

1. Remove the two screw plugs, peel off the nameplate, and use an appropriate screwdriver to detach the three screws connecting the housing to the main unit. Push the housing assembly forward while pulling the main unit assembly backward (take care to avoid excessive force that may damage the wiring harness), then remove the main unit assembly.

2. Disconnect all wiring connectors from the PCB board, then unplug the motor wiring harness.

3. Use an appropriate screwdriver to remove the three screws securing the battery pack assembly, then detach the battery pack assembly from the housing assembly.

4. Tear off the sealing sheet on one side of the battery pack, remove the screws on the PCB board, and cut off the nickel sheet connecting the battery cell to the PCB board (be careful not to touch the positive and negative to cause a short circuit). Remove the two screws above and below the bracket, separate the bracket and the battery cell for scrapping.

• **Environment Protection** EN



All products bearing this symbol are waste electrical and electronic equipment (WEEE as in directive 2012/19/EU) which should not be mixed with unsorted household waste. Instead, you should protect human health and the environment by handing over your waste equipment to a designated collection point for the recycling of waste electrical and electronic equipment, appointed by the government or local authorities. Correct disposal and recycling will help prevent potential negative consequences to the environment and human health. Please contact the installer or local authorities for more information about the location as well as terms and conditions of such collection points.

• **FAQ** EN

⚠ Note: Before troubleshooting, disconnect the power supply and pull out the power plug.

Fault	Possible reason	Solution
The appliance does not work.	Low battery.	Charge the battery in time.
	High temperature due to prolonged use.	Leave the appliance to cool down, then turn on the power again.
	Power button is not pressed to turn on the appliance.	Press and hold the power button for 1.5 seconds to turn on the appliance.
	Motor anti-jam protection activated.	Clear the blocked foreign matter in the air duct.
	Brush head anti-tangle protection activated.	Clear obstructions from the brush head.
Weak suction power.	Damaged motor or battery.	Contact the after-sales service.
	The dust cup is full.	Clean the dust cup.
Excessive noise.	Extensive rod's air duct is blocked by foreign objects.	Clean the extensive rod.
	The filter is clogged or not sufficiently dried after cleaning.	Clean the filter and dry it well.
	The dust cup is full.	Clean the dust cup.

• **FAQ** EN

Fault	Possible reason	Solution
The appliance cannot be charged.	The air duct is blocked by foreign objects.	Clear the air ducts of foreign objects.
	The connected power socket is not compliant or not plugged in securely.	Connect to a power outlet that meets the appliance's requirements and ensure secure contact.
	The power adapter is not plugged in securely with the charging port.	Connect the power adapter to the charging port firmly.
Battery level indicator does not flash during charging.	The power adapter is damaged.	Contact the after-sales service.
	The power adapter is not compatible with the appliance.	Use the power adapter supplied with the appliance for charging.

Caution:  
• If the appliance malfunctions during use, please turn off the appliance before handling.  
• If the problem is not solved, please contact the after-sales service.

• **Product Specification** EN

**Main unit**

Product model: VCB01B  
Rated voltage: 22.2 V ---  
Charging voltage: 2.6 V ---  
Charging current: 0.5 A

Rated power: 265 W  
Dust cup effective volume: 0.4 L  
Dust cup maximum volume: 0.56 L  
Battery capacity: 2200 mAh

**Soft roller brush head**

Model: VCFB1B  
Rated voltage: 12 V ---

Rated power: 15 W

**Power adapter**

Model: ZD012M260050EU  
Input: 100-240 V- 50/60 Hz 0.5 A  
Output: 2.6 V --- 0.5 A

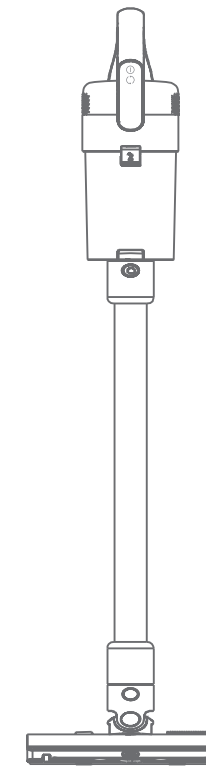

**T20FLIP**  
Deerma  
Cordless Vacuum Cleaner

**User Manual**

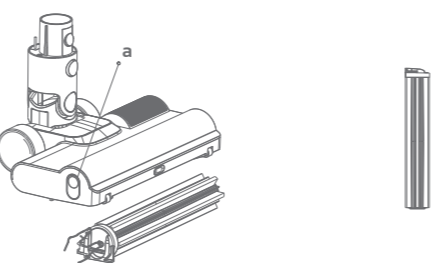
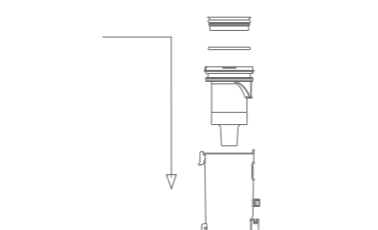
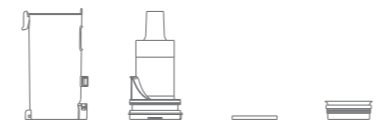
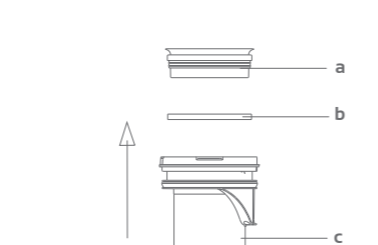
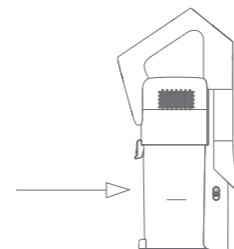
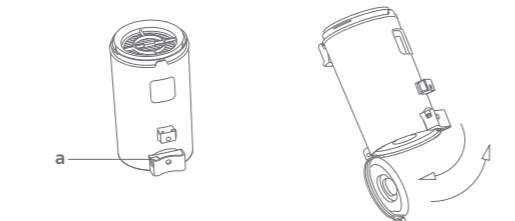
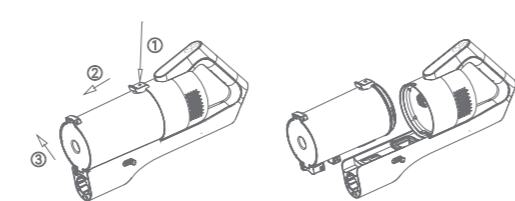
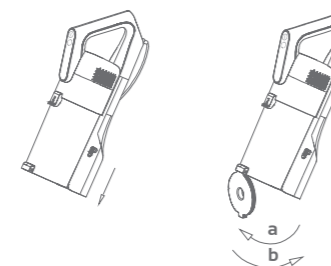
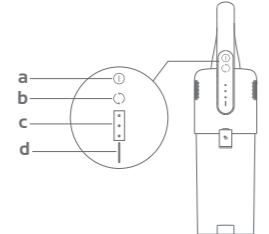
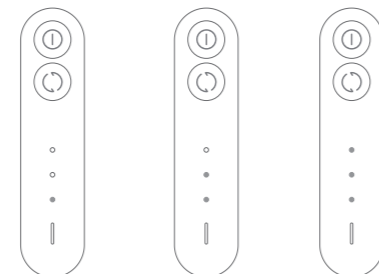
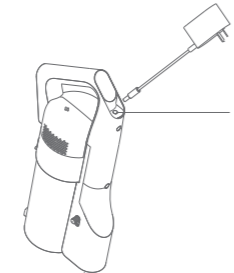
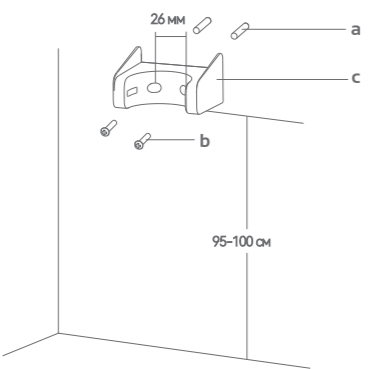
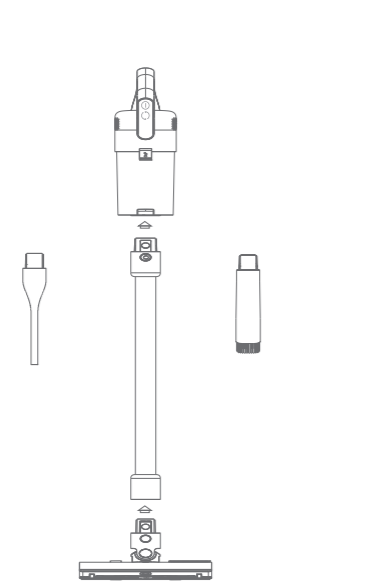
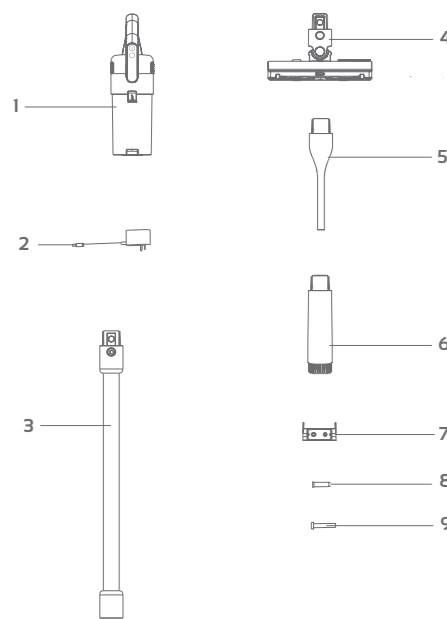
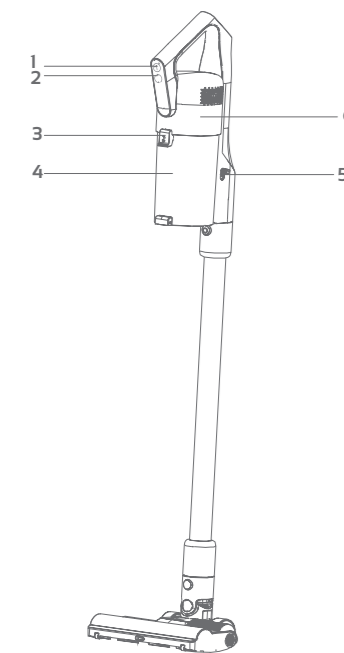
**Attention**

Please read this instruction manual carefully before using the product and keep it properly.

**1. Storage**

- Be careful when handling the vacuum cleaner to prevent impacts.
- Do not place the vacuum cleaner close to fire sources or other high-temperature areas.
- Do not use or store the vacuum cleaner under extremely adverse conditions, such as extreme temperatures. It is recommended to use it in an indoor environment with a temperature between 5°C and 35°C.
- Store the appliance in a cool and dry place.
- If not in use for a long time, it is recommended to charge the appliance once every three months.

**2. Before Use**

- Please operate according to the instructions in the manual. Otherwise, it may cause damage to the product itself or personal injury.
- When using the vacuum cleaner for the first time or replacing a new filter, make sure that the filter is properly installed.
- Before charging, please first check whether the charging cable is in good condition.
- If the power adapter is damaged, you must purchase special components from the manufacturer or the maintenance department for replacement.
- If the supply cord is damaged, it must be replaced by the manufacturer, its service agent or similarly qualified persons in order to avoid a hazard.

**3. During Use**

- This product is only intended for use in indoor environments such as homes, hotels, and schools. Do not use it outdoors or in industrial environments.
- This appliance is not intended for use by persons (including children) with reduced physical, sensory or mental capabilities, or lack of experience and knowledge, unless they have been given supervision or instruction concerning use of the appliance by a person responsible for their safety.
- Children should be supervised to ensure that they do not play with the appliance.

**Attention**

- This appliance can be used by children aged from 8 years and above and persons with reduced physical, sensory or mental capabilities or lack of experience and knowledge if they have been given supervision or instruction concerning use of the appliance in a safe way and understand the hazards involved. Children shall not play with the appliance. Cleaning and user maintenance shall not be made by children without supervision.
- Do not touch the power cord plug or use the product with wet hands to prevent injuries.
- Do not use the vacuum cleaner in flammable and explosive gases.
- Do not use to pick up any liquids (such as water, flammable and explosive liquids like gasoline, or toxic solutions such as chlorine bleach, ammonia, and sewer cleaners).
- Do not use to pick up any burning or smoking objects (e.g. unextinguished cigarette butts, matches, etc).
- Do not use to pick up hard or sharp objects (e.g. renovation waste, nails, etc).

**2. Before Use**

- Do not use to pick up tiny particles like cement, gypsum powder, and wall powder, or large objects like toys, and paper balls, to avoid causing malfunction of the appliance.
- Do not allow limbs or other body parts of people or pets to get close to the rotating brush head to avoid injury.
- Do not operate the vacuum cleaner for a long time when the suction inlet or air blocked to avoid damaging the vacuum cleaner.
- Do not use the vacuum cleaner without installing the dust cup assembly.
- Do not place the vacuum cleaner on unstable surfaces such as chairs or dining tables to avoid damage or personal injury.
- If abnormal noises are found in the motor during use, please stop using it and perform troubleshooting. If the problem cannot be solved, please contact the after-sales service.
- Do not disassemble or assemble the machine privately.
- This appliance contains a lithium battery. Lithium batteries are hazardous goods. In case of failure, please contact the after-sales service. It is prohibited to disassemble and repair it privately.
- This appliance contains batteries that are only replaceable by skilled persons. Do not use any third-party batteries.
- WARNING: For the purposes of recharging the battery, only use the detachable supply unit provided with this appliance.

**3. During Use**

- This product is only intended for use in indoor environments such as homes, hotels, and schools. Do not use it outdoors or in industrial environments.
- This appliance is not intended for use by persons (including children) with reduced physical, sensory or mental capabilities, or lack of experience and knowledge, unless they have been given supervision or instruction concerning use of the appliance by a person responsible for their safety.
- Children should be supervised to ensure that they do not play with the appliance.

1. Power button
2. Mode switching button
3. Dust cup release button
4. Dust cup
5. Dust cup bottom cover release trigger
6. Main unit

Note: The illustrations in this manual are for reference only. Please refer to the actual product.

Fig. A-1

**Accessory List**

1. Main unit
2. Power adapter
3. Extensive rod
4. Soft roller brush head
5. Long crevice nozzle
6. Wide crevice nozzle
7. Storage holder
8. Wall plug \*2
9. Screw \*2

Fig. A-2

## • Assembly

**Installing the main unit and accessories**

Fig.B-1

**Installing the storage holder**

1. Drill two holes with a diameter of 6mm on the wall at the height of 95-100cm from the ground according to the diagram, and then insert wall plugs into the holes.
2. Peel off the protective film from the adhesive pad on the back of the storage holder. Align the holes on the storage holder with the sleeves of the wall plugs, press it against the wall, then tighten the two screws to secure the storage holder to the wall.

Note:

- When not in use, place the brush flat on the ground and hang the vacuum vertically on the storage holder.
- The storage holder should be fixed near the socket, so that the power adapter can be inserted for charging.

Fig. B-2

- a. Wall plug
- b. Screw
- c. Storage holder

## • Charging

Insert the power adapter end into the charging port first, then insert the plug into an electrical outlet. Make sure the power adapter is connected to the outlet in place.

- a. Charging port

Fig. C-1

**Instructions of battery level indicator**

- One white indicator light: battery level < 20%
- Two white indicator lights: 20% battery level < 60%
- Three white indicator lights: 60% battery level ≤ 100%

Fig.C-2

Note:

- It is recommended to fully charge the appliance before using it for the first time.
- The appliance will not operate while charging.
- While the appliance is charged fully, all 3 white indicator lights stay steady for 1 minute, and then turn off. The appliance enters standby.

- a. Power button
- b. Mode switching button
- c. Battery level indicator
- d. Mode indicator

1. Turn on/off: press and hold the power button for 15s, and the vacuum cleaner will start working. The default setting upon startup is the standard mode. Press the power button again, and the appliance will stop working.
2. Switch mode: while the vacuum cleaner is running, press the mode switching button to switch to the strong mode, and the mode indicator will stay on in green. Press the mode switching button again to switch back to the standard mode.

Fig. D-1

## • Care and Maintenance

Warning:

- Before cleaning and maintaining the appliance, turn off the appliance and unplug the power plug.

Note:

- Clean the dust cup regularly to avoid excessive accumulation of dust clogging the air duct, resulting in reduced suction power.
- It is recommended to disassemble the dust cup above the trash can to avoid dust falling on the floor.